

London LGBTQ Community Centre.

This is a project I am really interested in as it was designed by Architect Martha Summers, who was named amongst the Rising Stars of 2023 by The RIBA Journal. Martha focuses on designing queer and feminist spaces so in terms of my theme is a really good designer to look at.

Located in London's South-bank, the project London LGBTQ Community Centre was designed and constructed in just 5 weeks. Martha Summers enlisted a team of only LGBT+ people to build it. The community project aimed to be a "permanent safe, sober, intergenerational, intersectional LGBTQ+ Community Centre."

The space is created to be flexible to the needs of the community within. That means the design was orientated around a large open space that multiple events could take place in.





This was intended to removed a fixed or designed feel from the space. Summers wanted to create a sense of being safe and cosy but not prentious or precious. This balanced allows for a community to feel like they can make a space theirs.

They first look random array of furniture within the space was actually carefully decided on in order to create a mix n match feeling – “It’s more like a big house where everyone’s brought their own chair.”



The Quiet Room –

One of the really interesting spaces within the design is the Quiet Room. This space is aimed create a more private space to allow of services such as or outreach, HIV testing, counselling, and other similar needs.

I think this space shows the importance on open and closed spaces in community projects, it is essential there are safe and private areas too.

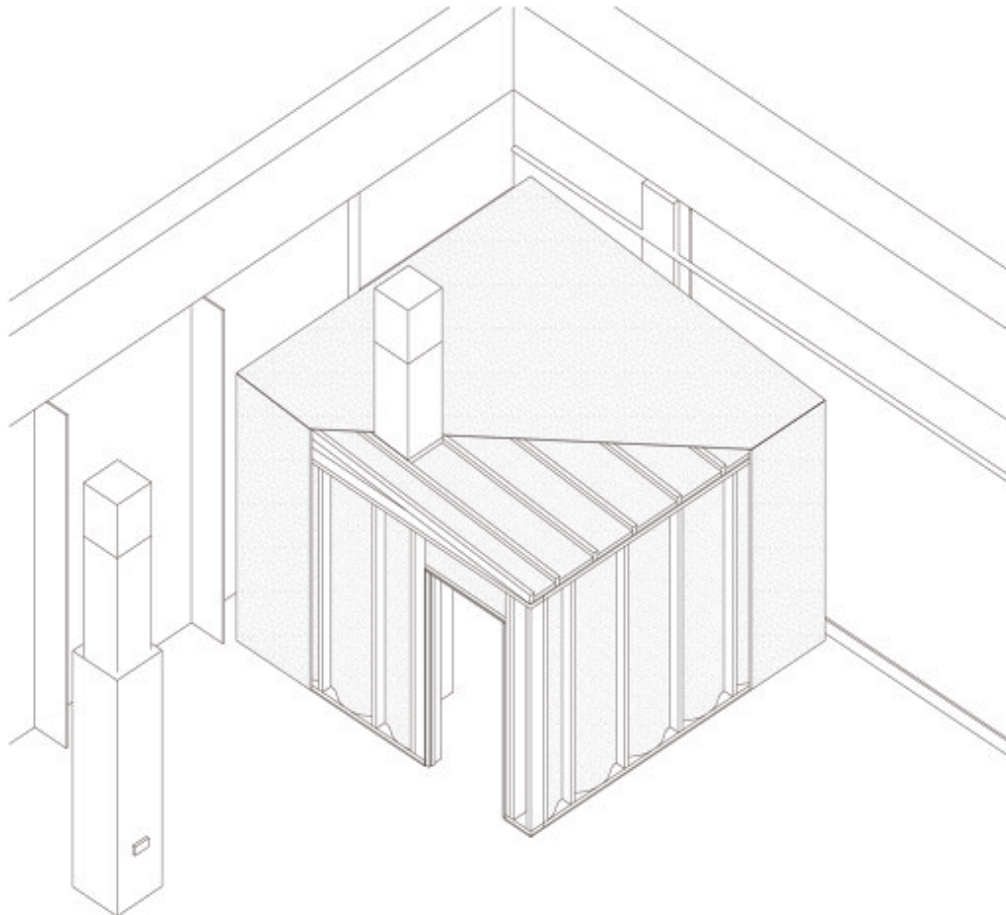



Sources :

<https://www.ribaj.com/intelligence/rising-stars-2023-martha-summers>

<https://marthasummers.co.uk/London-LGBTQ-Community-Centre-Pop-Up-2021>