

MAPPING THE SOUNDSCAPE – MY FLAT PT.1

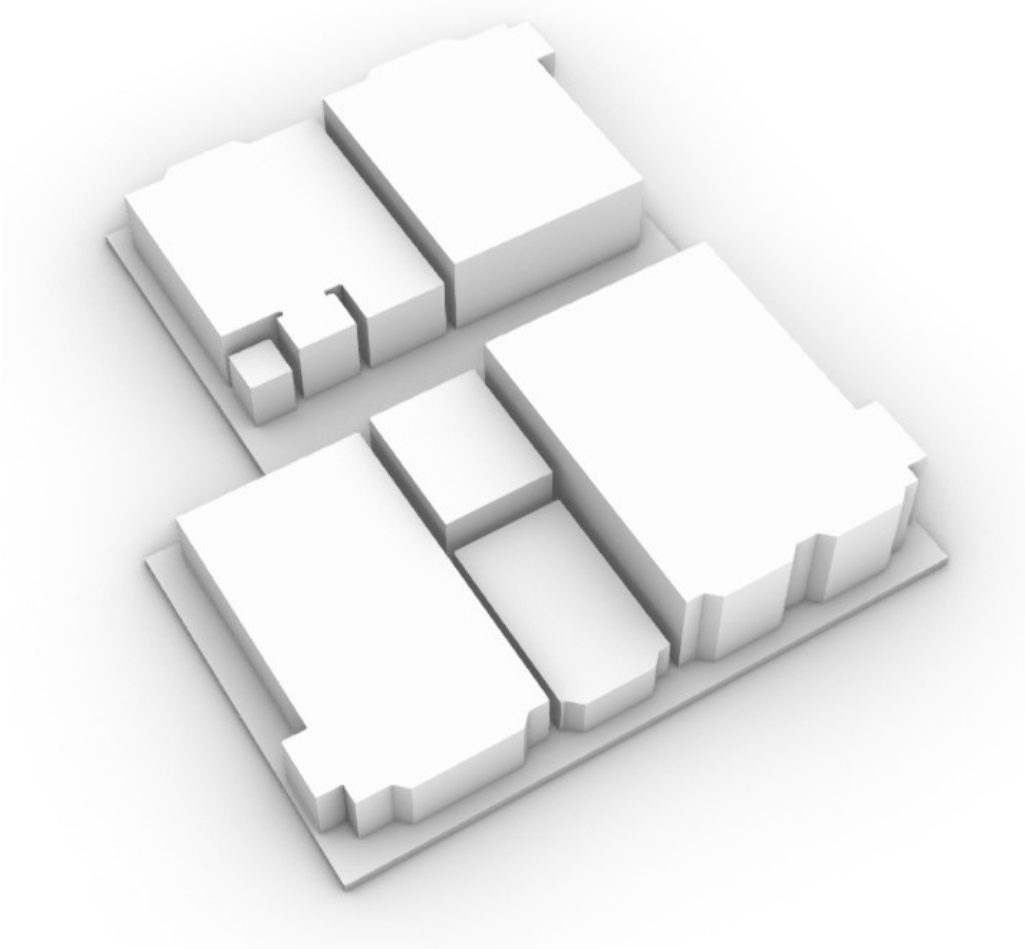

After finishing my work on the meadows I couldn't see how I could further develop it. Therefore, I decided to move my focus onto another place, this time on a far smaller scale, and a place more personal. My flat.

Instead of recording sounds, I returned to Rhino, and began by creating a model of my flat, excluding the rooms and any doors. Following this, I did the opposite, creating a model of my flat, extruding volumes representing the rooms from within the walls. In order to tackle the topic of measuring sound, when extruding the volumes, with each representing a room, I did so in a way where each volume is comparable to each other, with respect to sound. Rooms that made the most noise had the largest volume, and so on. In doing so, I created a model which represents the sounds of my flat.